

SENA

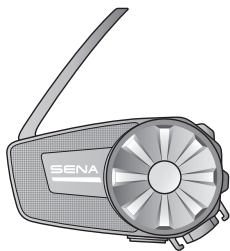

SPIDER ST1

MOTORCYCLE MESH COMMUNICATION SYSTEM

HD SPEAKERS

QUICK START GUIDE

Downloadable Sena Software

Download the **Sena Motorcycles App** at [Google Play Store](#) or [App Store](#).



Sena Motorcycles

Download the following items at [sena.com](#).



Sena Device Manager

- Firmware upgrade
- Device configuration setting



**Quick Start Guide,
User's Guide**

Follow us on Facebook, YouTube, Twitter and Instagram to check the latest information and helpful tips.

SENA



SENA Technologies, Inc.
Customer Support: [sena.com](#)

Product Details

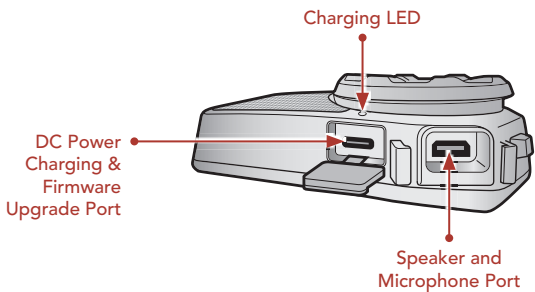
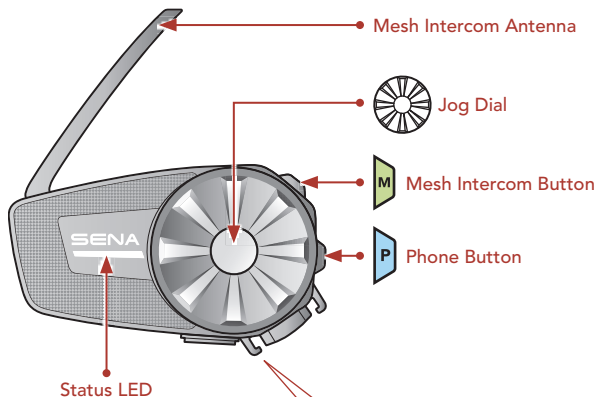

■ Installation

- For more information about installation, refer to the User's Guide.

Using the Clamp Unit

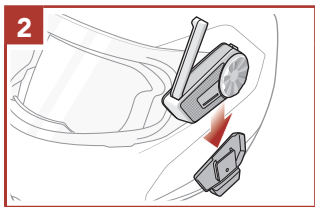
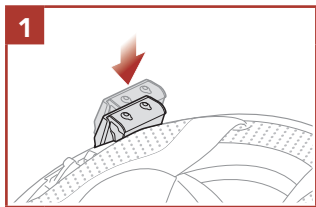

Using the Glued Surface Mounting Plate

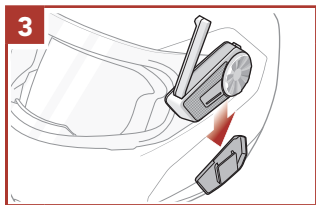
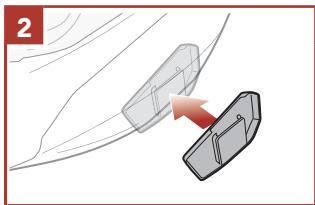
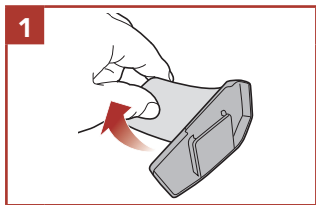

Installing the Speakers

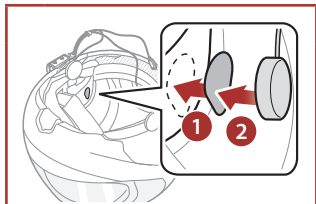

Installing the Wired Boom Microphone

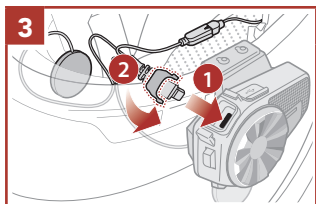
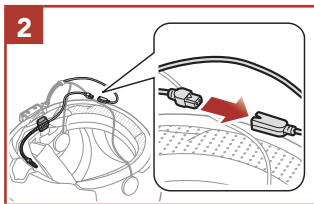
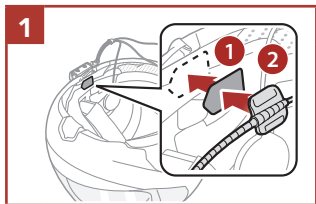

Installing the Wired Microphone

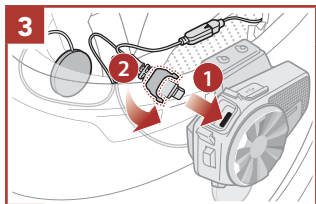
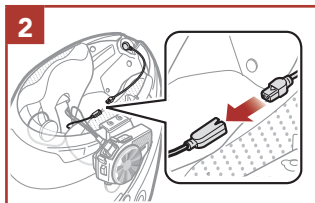
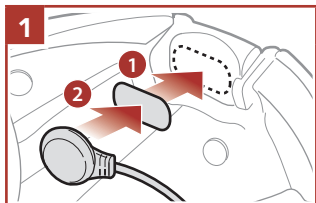

Mesh Intercom Antenna

Pull the Mesh Intercom Antenna outwards slightly to unfold it.

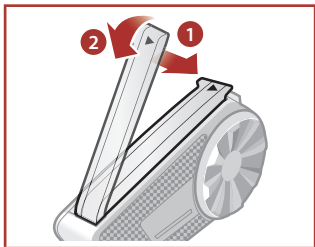

NOTICE

- This **Quick Start Guide (Version 2.0.0 or higher)** explains how to operate the SPIDER ST1 with **firmware version 2.0.0 or higher**.
- For operating the SPIDER ST1 with a **firmware version lower than 2.0.0**, refer to the **SPIDER ST1 Quick Start Guide** that is available when you connect the SPIDER ST1 to the **Sena Motorcycles App**.

Icon Legend



Tap button/Jog Dial the specified number of times



Press and Hold button/Jog Dial for the specified amount of time



Rotate Jog Dial clockwise (right) or counterclockwise (left).



Rotate while Pressing Jog Dial clockwise (right) or counterclockwise (left).



"Hello"

Audible prompt

Basic Operations

Powering On

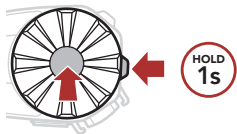

Powering Off

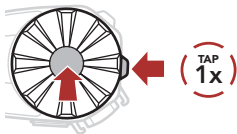

Volume Up



Volume Down



Checking the Battery Level

Powering On

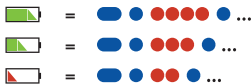

■ Phone Pairing



- ② Select **SPIDER ST1** in the list of Bluetooth devices detected.



- For more information on phone pairing, refer to the User's Guide.

Using the Phone

Answer a Call

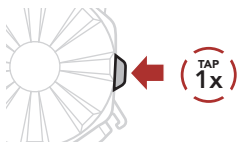

End a Call

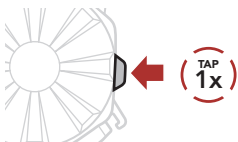

Reject a Call



Voice Dial

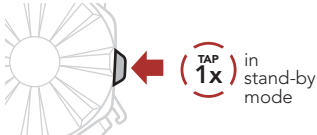

Music Control

Play/Pause



Track Forward

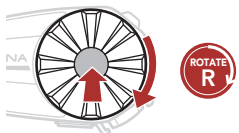

Track Backward



■ Mesh Intercom™

Open Mesh™: communication within the same channel.

Group Mesh™: communication within the same private group.

- For more information on **Mesh Intercom**, refer to the User's Guide.

Mesh Intercom On



TAP
1x



Blinking 



"Mesh intercom on,
Open Mesh, channel 1"

Mesh Intercom Off



TAP
1x



"Mesh intercom off"

Note: When **Mesh Intercom** is on, the **SPIDER ST1** will automatically connect to nearby **SPIDER ST1** users and the headset will be in **Open Mesh (default: channel 1)** initially.

Open Mesh

Channel Setting (Default: channel 1) in Open Mesh

Using the Button

- ① Enter into the **Channel Setting**.



- ② Navigate between channels.
(1 → 2 → ●●● → 8 → 9 → Exit → 1 → ●●●)

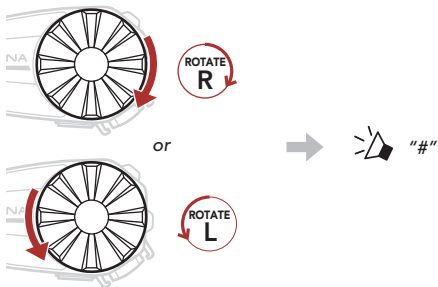

- ③ Save the channel.



Using the Sena Motorcycles App

You can select the channel through the **Sena Motorcycles App**.

Group Mesh

Group Mesh is a closed group intercom function that allows users to join, leave, or rejoin a group intercom conversation without pairing each headset.

1) Creating a Group Mesh

Creating a **Group Mesh** requires **two or more Open Mesh users**.

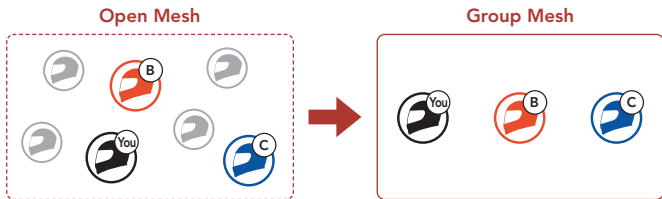

- ① **Users (You, B, and C)** enter into **Mesh Grouping** to create a **Group Mesh**.



- ② When **Mesh Grouping** is completed, the **users (You, B and C)** will hear a voice prompt on their headset as **Open Mesh** switches to **Group Mesh**.



2) Joining an Existing Group Mesh

One of the **current users** in an **Existing Group Mesh** can allow **new users (one or more)** in **Open Mesh** to join the **Existing Group Mesh**.

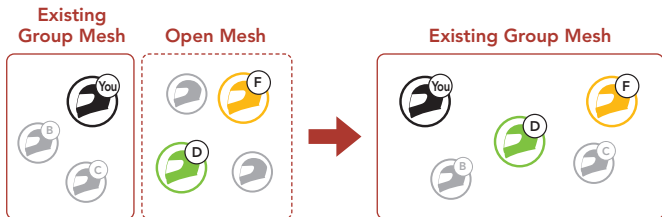

- ① One (**You**) of the **current users** in the **Existing Group Mesh** and **new users (D and F)** in **Open Mesh** enter into **Mesh Grouping** to join the **Existing Group Mesh**.



- ② When **Mesh Grouping** is completed, the **new users (D and F)** will hear a voice prompt on their headset as **Open Mesh** switches to **Group Mesh**.



■ Enable/Disable Mic (Default: Enable)

Users can enable/disable the microphone when communicating in a **Mesh Intercom**.



■ Mesh Reach-Out Request

You (caller) can send a request message to turn on the Mesh Intercom to nearby friends who have it turned off.

- ① If you want to send or receive a request message, you need to enable **Mesh Reach-Out** on the **Sena Motorcycles App**.
- ② While your headset's Mesh Intercom is on, you (caller) send a request message using the **headset's Button** or the **Sena Motorcycles App**.

[Caller]



[Caller]

 "Mesh reach-out request"

[Nearby Friends]

 "Mesh intercom requested"

- ③ Friends who receive the request message need to manually turn on their Mesh Intercom using the **headset's Button** or the **Sena Motorcycles App**.

Reset Mesh

If a headset in an **Open Mesh** or **Group Mesh** resets the **Mesh**, it will automatically return to **Open Mesh (default: channel 1)**.



Configuration Menu

Accessing the Configuration Menu



Navigating Between Menu Options



Execute Menu Options

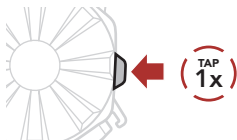

Troubleshooting

Factory Reset





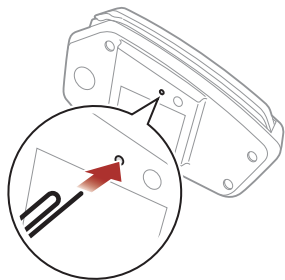

















Fault Reset



Note: **Fault Reset** will not restore the headset to the factory default settings.

Quick Reference

TYPE	OPERATION	BUTTON COMMANDS
 Basic Operations	Power on/ Power off	 
	Volume up/Volume down	 or 
 Mobile Phone	Answer phone call	
	End phone call	
	Reject phone call	
	Voice Dial	
 Music	Play/Pause music	
	Track forward	
	Track backward	

TYPE	OPERATION	BUTTON COMMANDS
 <p data-bbox="104 471 228 518">Mesh Intercom™</p>	Mesh Intercom on/off	
	Channel setting	
	Mesh Grouping	
	Enable/Disable Mic	
	Mesh Reach-Out Request	
	Reset Mesh	