

SENA

105

Quick Start Guide

Motorcycle Bluetooth®
Communication System

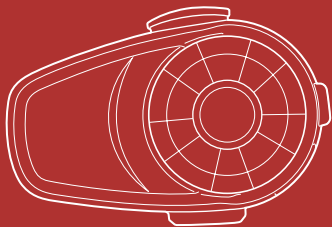

You can download the **full version of the manual** and view other Sena products at the Sena website: www.sena.com.

2.0.0

PREPARATION

Knowing the Headset Layout

Headset

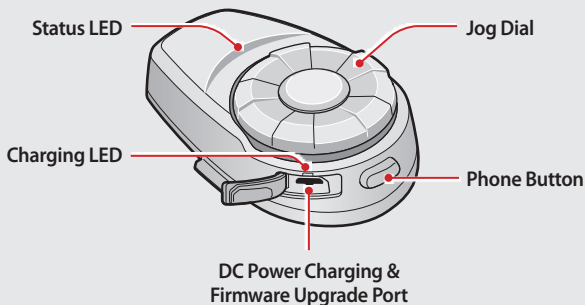

Clamp Unit

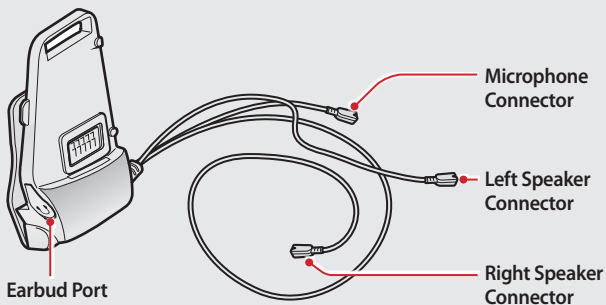

Installing the Headset

Clamp Unit

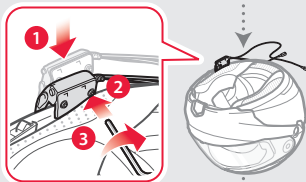
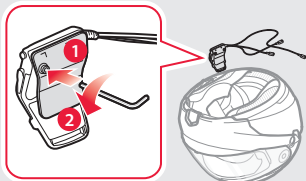

Headset

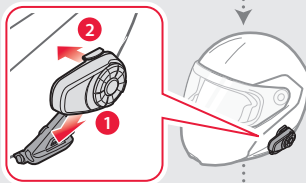

Speaker

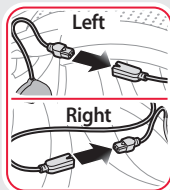

Microphone

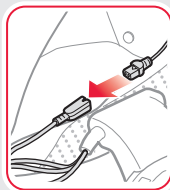
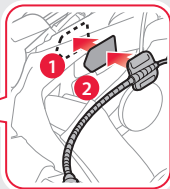

Sena Motorcycles App

Download

- Android: Google Play Store > Sena Motorcycles
- iOS: App Store > Sena Motorcycles

Sena Device Manager

The Sena Device Manager allows you to upgrade the firmware and configure its settings directly from your PC or Apple computer. Download the Sena Device Manager from sena.com.

BASIC OPERATION

Operating the Buttons



Tap the button



Double tap the button

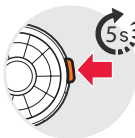

Press and hold the button for 5 seconds





Press the two buttons at the same time



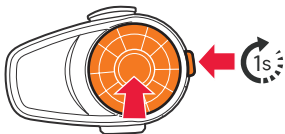

Rotate the Jog Dial

Turning On/Off the Headset



ON  You will hear **ascending beeps**.

 "Hello"

OFF  You will hear **descending beeps**.

 "Good bye"

Simultaneously press and hold the **Jog Dial** and the **Phone Button** for 1 second to turn on or off the headset.

Adjusting the Volume

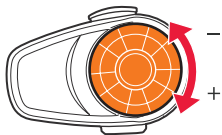

 You will hear a **beep** when the volume reaches the maximum or minimum level.

Checking the Battery Level

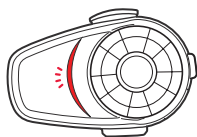

Blinking		70~100%
Blinking		30~70%
Blinking		0~30%

Turn on the headset and check the battery level via the **Status LED**.

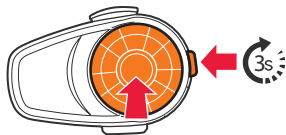

	"High"	70~100%
	"Medium"	30~70%
	"Low"	0~30%

Or, press and hold the **Jog Dial** and the **Phone Button** for 3 more seconds when the headset turns on. You will hear a **triple beep** and a **voice prompt**.

Charging the Battery

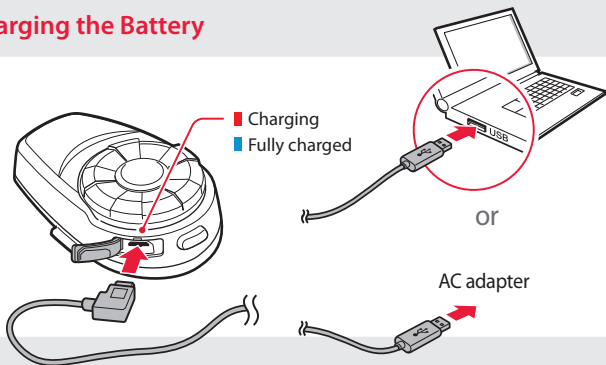

PAIRING

Pairing with Mobile Devices - Phone, Music

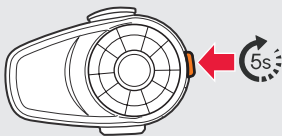

🔊 "Phone pairing"

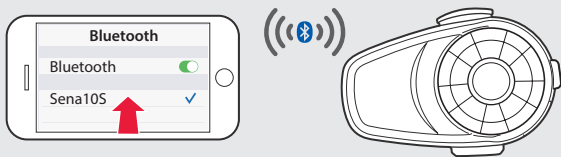

🔊 "Your headset is paired"

- The headset will enter the Phone Pairing mode automatically when you initially turn on the headset.
- For more information on phone pairing, refer to the User's Guide.

Using Phone Features

After Pairing...

Answering Calls

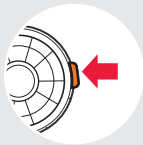

or



or



Ending Calls

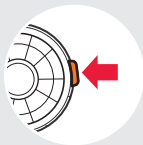

or



🔊 until you hear a beep

Rejecting Calls



🔊 until you hear a beep

Making Calls

Using the Phone Keypad

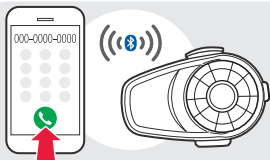

Using the Voice Dialer

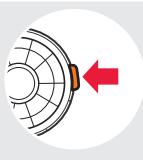

Using the Speed Dial



🔊 You will hear a beep.

🔊 "Speed dial"

Voice Menu

- Last number redial
- Speed dial 1
- Speed dial 2
- Speed dial 3
- Cancel

Listening to Music

After Pairing...

Playing or Pausing Music



🔊 until you hear
a double beep

Tracking Forward or Backward





Rotate While
Pressing

INTERCOM

Pairing with Other Headsets

Using the Smart Intercom Pairing (SIP)

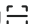
SIP allows you to quickly pair with your friends for intercom communication by scanning the QR code on the **Sena Motorcycles App** without remembering the button operation.

1. Pair the mobile phone with the headset.
2. Open the **Sena Motorcycles App** and tap  (**Smart Intercom Pairing Menu**).
3. Scan the **QR code** displayed on your friend (B)'s mobile phone.
 - Your friend (B) can display the QR code on the mobile phone by tapping  > **QR code**  on the **Sena Motorcycles App**.

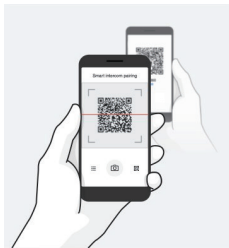

4. Tap **Save** and check that your friend (B) is paired with **you** (A) correctly.
5. Tap **Scan**  and repeat steps 3-4 to pair with **Intercom Friends** (C) and (D).



The **Smart Intercom Pairing (SIP)** is not compatible with Sena products that use **Bluetooth 3.0 or below**.

Using the Button

Headset A

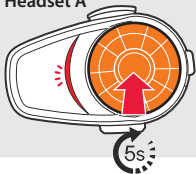

Headset B

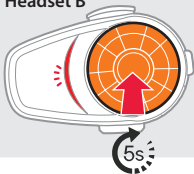

🔊 "Intercom pairing"

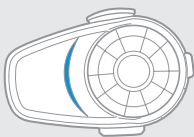
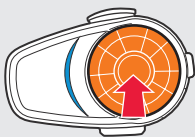

Follow the steps above to pair with two or more headsets.

Using the Intercom

After Pairing...

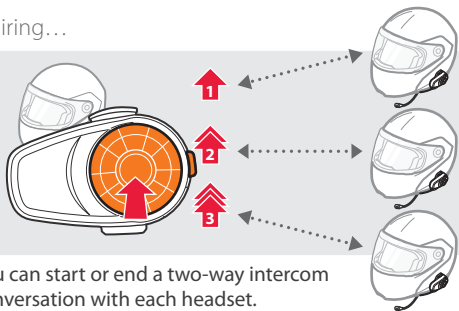

You can start or end a two-way intercom conversation with each headset.

SETTING

Using the headset

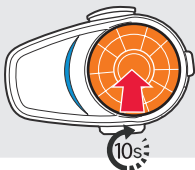

🔊 You will hear a **double beep sound**.

👂 “Configuration menu”

TROUBLESHOOTING

Factory Reset

If you want to restore the 10S to factory default settings, press and hold the **Phone Button** for 10 seconds. Tap the **Jog Dial**. The headset automatically restores the default settings and turns off.

Fault Reset

If the 10S is not working properly for any reason, push the pin-hole reset button located on the back of the headset.

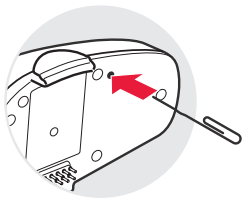

SENA



Sena Technologies Co., Ltd.
Customer Support: sena.com

105 Quick Reference

Type	Operation	Button Command	LED
Basic Function	Power on	Press the Phone Button and the Jog Dial for 1 second	Solid blue
	Power off	Press the Phone Button and the Jog Dial	Solid red
	Volume adjustment	Rotate the Jog Dial	-
Mobile phone	Mobile phone pairing	Press the Phone Button for 5 seconds	Blue & red alternatively flashing
	Second mobile phone pairing	Press the Jog Dial for 5 seconds	Red flashing
		Tap the Phone Button within 2 seconds	
	Answer mobile phone call	Tap the Phone Button or the Jog Dial	-
	End mobile phone call	Tap the Phone Button or press the Jog Dial for 2 seconds	-
	Voice dial	Tap the Phone Button	-
	Speed dial	Double tap the Phone Button	-
Reject incoming call	Press the Jog Dial for 2 seconds	-	
Intercom	Intercom pairing	Press the Jog Dial for 5 seconds	Red flashing
		Tap the Jog Dial of any one of the two headsets	
	Start/End each intercom	Tap the Jog Dial	-
	End all intercoms	Press the Jog Dial for 3 seconds	Blue flashing
	Start Group Intercom	Press the Jog Dial for 3 seconds	Green flashing
End Group Intercom	Press the Jog Dial for 3 seconds	-	
Music	Play/Pause Bluetooth music	Press the Jog Dial for 1 second	-
	Track forward/back	Rotate the Jog Dial while pressing	-
Reset	Factory reset	Press the Phone Button for 10 seconds	Solid red
		Tap the Jog Dial within 10 seconds	
	Fault reset	Press the Reset Button	-